

The information contained in this drawing is the sole property of CWS Coil Winding Specialist. Any reproduction in part or whole without written permission of CWS Coil Winding Specialist is prohibited.

| REVISION HISTORY | | | | | | |
|------------------|-----|------------------------------|-------------|---------|------|---------|
| REV | ECN | DESCRIPTION | SIGN & DATE | | | |
| | | | BY | DATE | CHK | DATE |
| A | | PRODUCTION RELEASE | TDK | 7/16/06 | JLAU | 7/16/06 |
| B | | REVISED DIMENSIONS | RL | 7/17/06 | JLAU | 7/17/06 |
| C | | ADDED NOTE #8, 9, 10, AND 11 | KLC | 10/7/08 | CT | 10/7/08 |
| D | | UPDATED | RCL | 7/11/11 | JLAU | 7/11/11 |

11 BUILD TO RoHS COMPLIANCE AND LEAD FREE

OR OVEN CURED AS REQUIRED

10 DIP-VANISH WITH AC43 OR BC-346A OR EQUAL

9 THIS IS CRITICAL MAXIMUM DIMENSION

8 BOTTOM OF CORE TO START OF TINNING
6.5±0.5 MM DIMENSION MEASURED FROM

7 TOP OF CORE TO START OF TINNING
13.5 MM DIMENSION MEASURED FROM

6 USING A PERMANENT MARKING METHOD
MARK PART NUMBER AND REVISION
WRAP INDUCTOR WITH TAPE, (PER NOTE 2)

5 TO THE CORE
MUST REST FLAT ON PCB). LEADS MUST BE TANGENT
FLUSH WITH THE COIL EDGE, AS SHOWN (I.E. COIL
REMOVE INSULATION AND TIN LEADS 7.0 MM MIN

4 SIDE OF CORE AND EVENLY SPACED, POLARITY NOTED
WIND SINGLE LAYER ON EACH
CONSTRUCTION:

3 TO INSURE INTERGRITY OF WINDING SEPARATION
HI-POT TEST FOR INTERWINDING ISOLATION= 250VDC
POWER LOSS= 5.2 W MAX.@ 100A/COIL
DCR= .40 mOHMS MAX./COIL
L= 52 uH MIN / COIL, 70 uH NOM / COIL, 1 KHZ, 1Vrms
SPECIFICATIONS @ 25 °C:

APPROVED PART

OUTER WRAP: 3M #11 OR #69 OR OTHER CWS

WIRE: UL RECOGNIZED 200°C RATING MAGNET WIRE

CWS BYTEMARK OR OTHER APPROVED PART

2 CORE: RATED 6000 VOLT FERRITE TOROID INSULATION, HIGH PERM MNZN

CLASS B (130°C) REQUIRED

1 MATERIAL: UL RECOGNIZED 94V-0 FOR FLAMMABILITY

NOTES: UNLESS OTHERWISE SPECIFIED, READ FROM BOTTOM UP

CAGE CODE = 5DME2

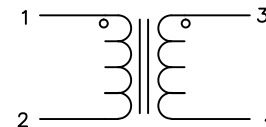
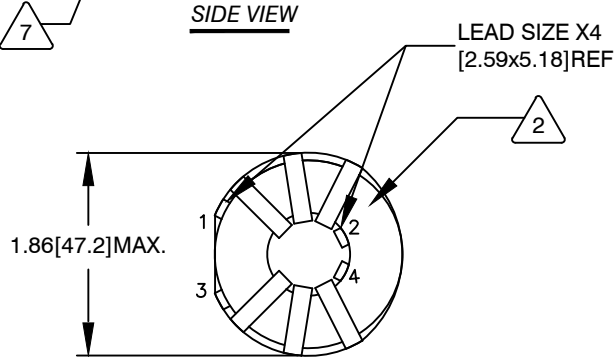
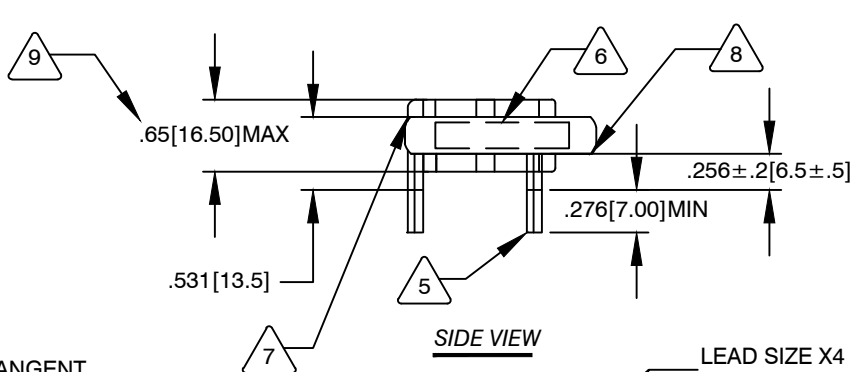

SCHEMATIC

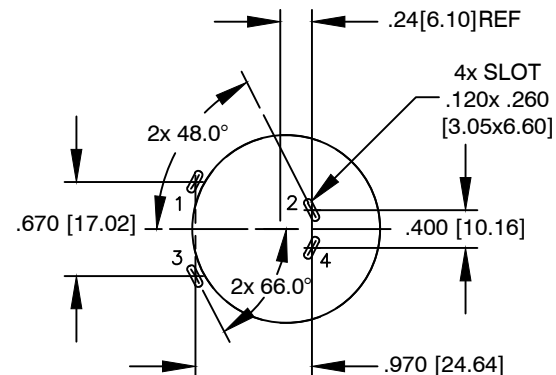

MOUNTING HOLES PATTERN

| UNLESS OTHERWISE SPECIFIED | |
|---|--|
| DIMENSIONING AND TOLERANCE PER ANSI Y14.5M | |
| ALL DIMENSIONS ARE IN INCHES AND [MILLIMETERS]. | |
| TOLERANCE INCHES: .XXX=±.010 .XX=±.020 $\sphericalangle=±0°30'$ | |
| TOLERANCE METRICS: .XXX=±.254 .XX=±.51 $\sphericalangle=±0°30'$ | |
| ANGLE PROJECTION | |
| DO NOT SCALE DRAWING | |

| QTY | CODE IDENT | MFG. P/N | DESCRIPTION | ITEM NO. |
|-------------------|------------|------------|--|--------------|
| PARTS LIST | | | | |
| AUTOCAD | | X | | |
| SOLIDWORKS | | | | |
| DRAWN | TDK | 7/16/06 | COILWS COM, INC www.coilws.com CWS Coil Winding Specialist. 353 W Grove Ave Orange, CA. 92865 | |
| CHECKED | JLAU | 7/16/06 | | |
| ENGR. | KSUM | 7/16/06 | TITLE: | |
| APPR. | JLAU | 7/16/06 | Inductor Common Mode 70uH 100A | |
| | SIZE | DWG. NO. | | REV |
| | B | C-36A29-09 | | D |
| | SCALE | 1=1 | | SHEET 1 OF 1 |

CAD-FILE: